

TERMINAL BOX, TYPE 3R



INDUSTRY STANDARDS

UL 1773 Listed; Type 3R; File No. E256098
 UL 50, 50E Listed; Type 3R; File No. E27525
 cUL Listed per CSA C22.2 No 94; Type 3R; File No. E27525

NEMA/EEMAC Type 3R
 IEC 60529, IP32

APPLICATION

These Terminal Boxes are wire-splice boxes for outdoor commercial and industrial applications that have a feeder tap to branch circuits. Boxes are available in three- or four-wire configurations in sizes up to 400 A.

FEATURES

- Drip-shield top and seam-free sides, front and back
- Removable cover
- Distribution lugs installed (see table for sizes)
- Hub opening at top with cover
- Provisions for padlocking or seal

- Knockouts on bottom of enclosure
- Grounding provisions

SPECIFICATIONS

- 16 gauge galvanized steel

FINISH

ANSI 61 gray polyester powder paint finish inside and out over galvanized steel.

ACCESSORIES

See also Accessories.
 Touch-Up Paint
 Interchangeable Bolt-on Hub
 Lug Assembly

BULLETIN: S90B3

Standard Product

Catalog Number	AxBxC in./mm	Volts	Phase	Amps	Number of Bars	Wire Range	G in./mm	H in./mm
TB3R101	18.00 x 8.00 x 4.50 457 x 203 x 114	120/240	1Ø	100	3	(6) #14-2/0	15.00 381	3.88 99
TB3R103	18.00 x 8.00 x 4.50 457 x 203 x 114	600	3Ø	100	4	(6) #14-2/0	15.00 381	3.88 99
TB3R103240	18.00 x 10.75 x 4.50 457 x 273 x 114	120/240	3Ø	100	4	(6) #14-2/0	15.00 381	3.88 99
TB3R201	23.00 x 12.00 x 4.50 584 x 305 x 114	120/240	1Ø	200	3	(6) #6-350MCM	20.00 508	5.50 140
TB3R203	23.00 x 12.00 x 4.50 584 x 305 x 114	600	3Ø	200	4	(6) #6-350MCM	20.00 508	5.50 140
TB3R203240	23.00 x 14.00 x 4.50 584 x 356 x 114	120/240	3Ø	200	4	(6) #6-350MCM	20.00 508	5.50 140
TB3R401	27.00 x 16.00 x 5.00 686 x 406 x 127	120/240	1Ø	400	3	(6) #4-600MCM	24.00 610	8.75 222
TB3R403	27.00 x 16.00 x 5.00 686 x 406 x 127	600	3Ø	400	4	(6) #4-600MCM	24.00 610	8.75 222

TB3R401 is UL and cUL for copper conductor only

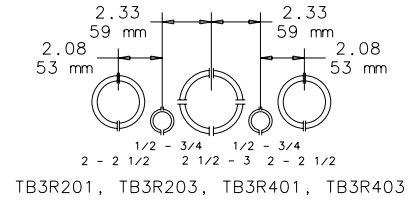
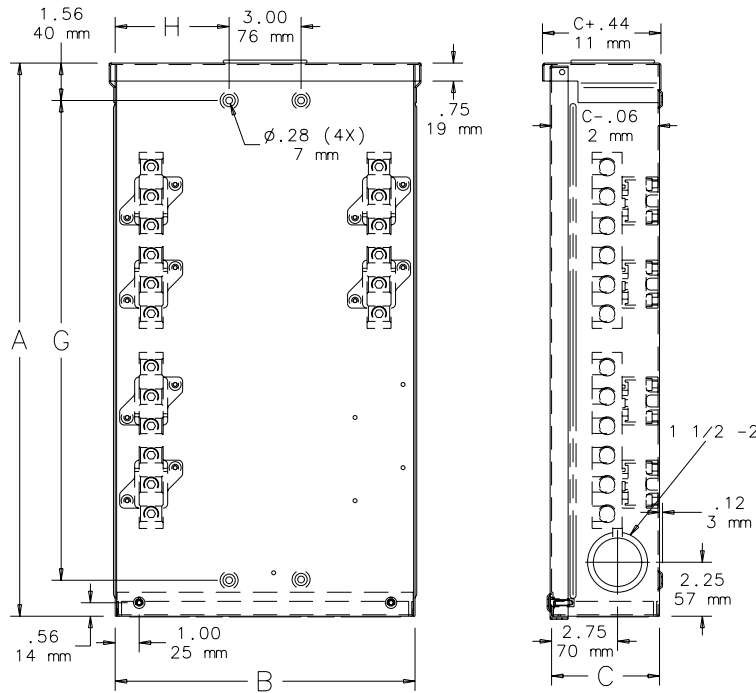

TB3R201, TB3R203, TB3R401, TB3R403

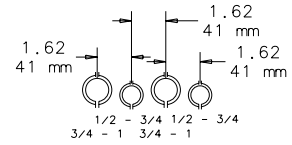

TB3R101, TB3R103

CONDUIT SIZES

Knockout Pattern
(from outside of box)

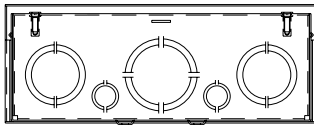

87790363

INTERCHANGEABLE BOLT-ON HUB



BULLETIN: S90B3

Catalog Number	Fits Conduit Size (in.)	Fits Conduit Size (mm)
TBHUB10	1.00	25
TBHUB12	1.25	32
TBHUB15	1.50	38
TBHUB20	2.00	51
TBHUB25	2.50	64

LUG ASSEMBLY



BULLETIN: S90B3

Catalog Number	Wire Range
TBL100	(6) #14-2/0
TBL200	(6) #6-350 MCM
TBL400	(6) #4-600 MCM

TERMINAL BOX, TYPE 3R



INDUSTRY STANDARDS

UL 1773 Listed; Type 3R; File No. E256098
 UL 50, 50E Listed; Type 3R; File No. E27525
 cUL Listed per CSA C22.2 No 94; Type 3R; File No. E27525

NEMA/EEMAC Type 3R
 IEC 60529, IP32

APPLICATION

These Terminal Boxes are wire-splice boxes for outdoor commercial and industrial applications that have a feeder tap to branch circuits. Boxes are available in three- or four-wire configurations in sizes up to 400 A.

FEATURES

- Drip-shield top and seam-free sides, front and back
- Removable cover
- Distribution lugs installed (see table for sizes)
- Hub opening at top with cover
- Provisions for padlocking or seal

- Knockouts on bottom of enclosure
- Grounding provisions

SPECIFICATIONS

- 16 gauge galvanized steel

FINISH

ANSI 61 gray polyester powder paint finish inside and out over galvanized steel.

ACCESSORIES

See also Accessories.
 Touch-Up Paint
 Interchangeable Bolt-on Hub
 Lug Assembly

BULLETIN: S90B3

Standard Product

Catalog Number	AxBxC in./mm	Volts	Phase	Amps	Number of Bars	Wire Range	G in./mm	H in./mm
TB3R101	18.00 x 8.00 x 4.50 457 x 203 x 114	120/240	1Ø	100	3	(6) #14-2/0	15.00 381	3.88 99
TB3R103	18.00 x 8.00 x 4.50 457 x 203 x 114	600	3Ø	100	4	(6) #14-2/0	15.00 381	3.88 99
TB3R103240	18.00 x 10.75 x 4.50 457 x 273 x 114	120/240	3Ø	100	4	(6) #14-2/0	15.00 381	3.88 99
TB3R201	23.00 x 12.00 x 4.50 584 x 305 x 114	120/240	1Ø	200	3	(6) #6-350MCM	20.00 508	5.50 140
TB3R203	23.00 x 12.00 x 4.50 584 x 305 x 114	600	3Ø	200	4	(6) #6-350MCM	20.00 508	5.50 140
TB3R203240	23.00 x 14.00 x 4.50 584 x 356 x 114	120/240	3Ø	200	4	(6) #6-350MCM	20.00 508	5.50 140
TB3R401	27.00 x 16.00 x 5.00 686 x 406 x 127	120/240	1Ø	400	3	(6) #4-600MCM	24.00 610	8.75 222
TB3R403	27.00 x 16.00 x 5.00 686 x 406 x 127	600	3Ø	400	4	(6) #4-600MCM	24.00 610	8.75 222

TB3R401 is UL and cUL for copper conductor only

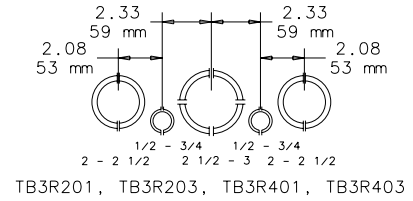
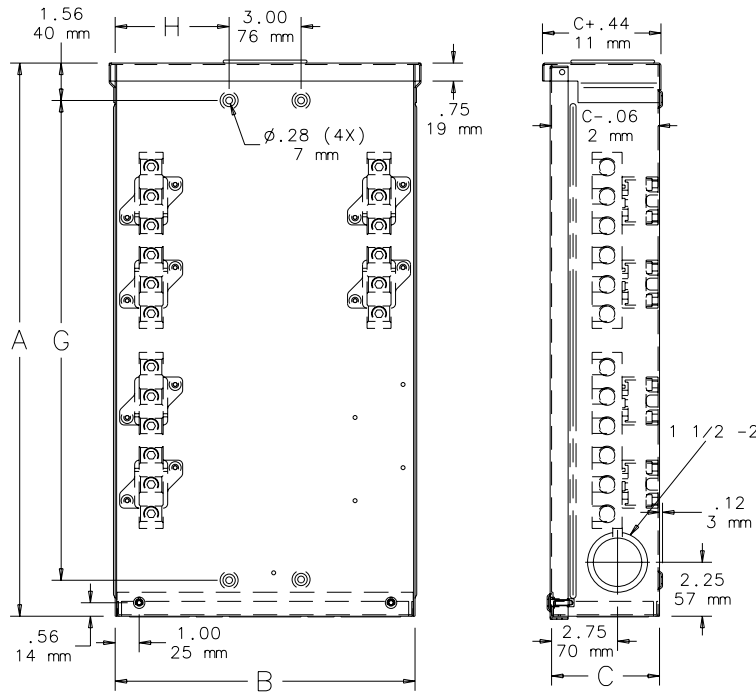

TB3R201, TB3R203, TB3R401, TB3R403

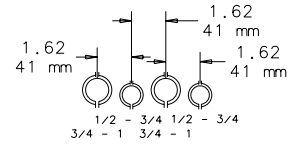

TB3R101, TB3R103

CONDUIT SIZES

Knockout Pattern
(from outside of box)

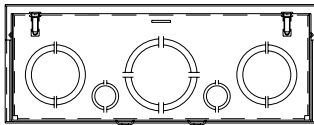

87790363

INTERCHANGEABLE BOLT-ON HUB



BULLETIN: S90B3

Catalog Number	Fits Conduit Size (in.)	Fits Conduit Size (mm)
TBHUB10	1.00	25
TBHUB12	1.25	32
TBHUB15	1.50	38
TBHUB20	2.00	51
TBHUB25	2.50	64

LUG ASSEMBLY



BULLETIN: S90B3

Catalog Number	Wire Range
TBL100	(6) #14-2/0
TBL200	(6) #6-350 MCM
TBL400	(6) #4-600 MCM