

UL Reduced Wall Steel Type RW FSC 5500 Series

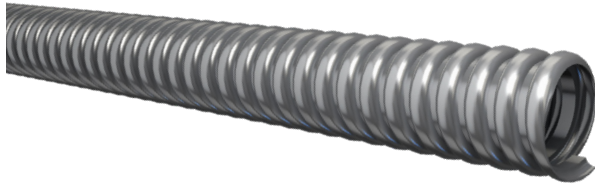

Description

- Reduced Wall Flexible Steel Conduit
- High grade hot dipped zinc galvanized low carbon steel
- Interlocking design
- Corrosion resistant
- Trade sizes 1½–4 are made with no solder joints

Applications

Suitable for use in:

- Flexible Steel Conduit (FSC): A raceway of circular cross-section made of helically wound, interlocked galvanized steel strip.
- Accordance with NEC® Article 348 Flexible Metal Conduit Type FMC
- Exposed and concealed locations
- Utilization equipment per NEC® 348.20(A)(2)(a)
- Suitable as part of a listed assembly per NEC® 348.20(A)(2)(b)
- Equipment ground in accordance with NEC® 250.118(5)
- Other Spaces Used for Environmental Air (Plenums) per NEC® 300.22(C)
- Cable Trays per NEC® 392.10(A) and Table 392.10(A)
- Raceway for Tap Conductors for Luminaires per NEC® 348.20(A)(2)(c) and 410.117(C)
- Connection to a motor terminal enclosure per NEC® 430.223
- Class I Division 2 per NEC® 501.10(B)(2)(2)
- Neon Secondary-Circuit Wiring 1000V or Less per NEC® 600.31(A)
- Neon Secondary-Circuit Wiring Over 1000V per NEC® 600.32(A)(1)
- Manufactured Wiring Systems per 604.100(A)(2)
- Elevators, Dumbwaiters, Escalators, Moving walks, Platform and Stairway Chairlifts per NEC® 620.21
- Under Raised Floors per NEC® 645.5(E)(1)(b)(10)
- Solar Photovoltaic (PV) Systems per NEC® 690.31(A)
- Fuel Cell Systems per NEC® 692.31
- Wind Electric Systems per NEC® 694.30(A)
- Critical Operations Power Systems (COPS) where flexibility is required per NEC® 708.10(C)(1)(3)(b)
- Optical Fiber Cables for installation within buildings per NEC® 770.110(A)(1)
- Communications Circuit Wires and Cables for installation within buildings per NEC® 800.110(A)(1)
- Community Antenna Television and Radio Coaxial Cables for installation within buildings per NEC® 820.110(A)(1)
- Low and Medium Power Network-Powered Broadband Cables for installation within buildings per NEC® 830.110(A)(1)

References & Ratings

- NFPA 70:
National Electric Code (NEC®) Articles 348, 250, 300, 392, 410, 423, 430, 501, 600, 604, 620, 645, 690, 692, 694, 708, 770, 800, 820 and 830
- UL 1
Standard for Flexible Metal Conduit
UL File Number E11831
Federal Specification WW-C-566C superseded by UL 1
- UL 1479
Fire Tests of Through-Penetration Firestops
UL File Number R14141
UL Classified Through-Penetrating Product for Use in Through-Penetration Firestop Systems
- NEMA RV 3
Application and Installation Guidelines for Flexible and Liquidtight Flexible Metal Conduits
- C22.2 No. 56
CSA Standard for Flexible Metal Conduit and Liquid-Tight Flexible Metal Conduit
The ¾ Trade Size is the only Type RW FMC that is CSA Certified

UL Reduced Wall Steel Type RW FSC 5500 Series



Ordering Information						Product Dimensions / Bend Radius		
Product Code	Trade Size		Coil Length (ft)	Reel Length (ft)	Approx. Weight per 100 ft (lbs)	Internal Diameter (min / max) (in)	External Diameter (min / max) (in)	Bend Radius (in)
	in	mm						
5501-22-00*	3/8	12	25	-	17	0.375 / 0.393	0.560 / 0.610	2
5501-24-00*	3/8	12	50	-	17	0.375 / 0.393	0.560 / 0.610	2
5501-30-00*	3/8	12	100	-	17	0.375 / 0.393	0.560 / 0.610	2
5501-42-00*	3/8	12	250	-	17	0.375 / 0.393	0.560 / 0.610	2
5501-45-00*	3/8	12	-	500	17	0.375 / 0.393	0.560 / 0.610	2
5501-60-00*	3/8	12	-	1000	17	0.375 / 0.393	0.560 / 0.610	2
5502-22-00	1/2	16	25	-	27	0.625 / 0.645	0.860 / 0.920	3
5502-24-00	1/2	16	50	-	27	0.625 / 0.645	0.860 / 0.920	3
5502-30-00	1/2	16	100	-	27	0.625 / 0.645	0.860 / 0.920	3
5502-45-00	1/2	16	-	500	27	0.625 / 0.645	0.860 / 0.920	3
5502-60-00	1/2	16	-	1000	27	0.625 / 0.645	0.860 / 0.920	3
5503-22-00	3/4	21	25	-	35	0.812 / 0.835	1.045 / 1.105	4
5503-24-00	3/4	21	50	-	35	0.812 / 0.835	1.045 / 1.105	4
5503-30-00	3/4	21	100	-	35	0.812 / 0.835	1.045 / 1.105	4
5503-45-00	3/4	21	-	500	35	0.812 / 0.835	1.045 / 1.105	4
5503-60-00	3/4	21	-	1000	35	0.812 / 0.835	1.045 / 1.105	4
5504-24-00	1	27	50	-	51	1.000 / 1.040	1.300 / 1.380	5
5504-80-00	1	27	-	300	51	1.000 / 1.040	1.300 / 1.380	5
5505-24-00	1 1/4	35	50	-	63	1.250 / 1.300	1.550 / 1.630	6.25
5505-40-00	1 1/4	35	-	200	63	1.250 / 1.300	1.550 / 1.630	6.25
5506-22-00	1 1/2	41	25	-	76	1.500 / 1.575	1.850 / 1.950	7.50
5506-35-00	1 1/2	41	-	150	76	1.500 / 1.575	1.850 / 1.950	7.50
5506-80-00	1 1/2	41	-	300	76	1.500 / 1.575	1.850 / 1.950	7.50
5507-22-00	2	53	25	-	100	2.000 / 2.080	2.350 / 2.450	10
5507-35-00	2	53	-	150	100	2.000 / 2.080	2.350 / 2.450	10
5508-22-00	2 1/2	63	25	-	165	2.500 / -	2.860 / 3.060	12.5
5508-35-00	2 1/2	63	-	150	165	2.500 / -	2.860 / 3.060	12.5
5509-22-00	3	78	25	-	197	3.000 / -	3.360 / 3.560	15
5509-30-00	3	78	-	100	197	3.000 / -	3.360 / 3.560	15
5510-22-00	3 1/2	91	25	-	230	3.500 / -	3.860 / 4.060	17.5
5510-30-00	3 1/2	91	-	100	230	3.500 / -	3.860 / 4.060	17.5
5511-22-00	4	103	25	-	263	4.000 / -	4.360 / 4.560	20
5511-30-00	4	103	-	100	263	4.000 / -	4.360 / 4.560	20

NOTE: All dimensions and weights are subject to normal manufacturing tolerances. *CSA certified. Review NEC® 348.60 and 250.118(5) for grounding requirements. Continuous length reels with no solder joints or connectors are available on sizes. Review NEC® 348.60 and 250.118(5) for grounding requirements.

UL Reduced Wall Steel Type RW FSC 5500 Series

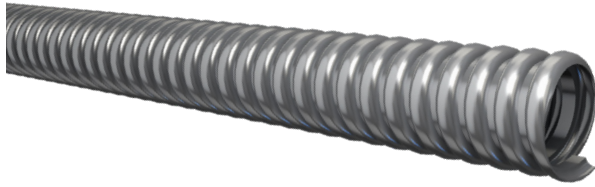

Description

- Reduced Wall Flexible Steel Conduit
- High grade hot dipped zinc galvanized low carbon steel
- Interlocking design
- Corrosion resistant
- Trade sizes 1½–4 are made with no solder joints

Applications

Suitable for use in:

- Flexible Steel Conduit (FSC): A raceway of circular cross-section made of helically wound, interlocked galvanized steel strip.
- Accordance with NEC® Article 348 Flexible Metal Conduit Type FMC
- Exposed and concealed locations
- Utilization equipment per NEC® 348.20(A)(2)(a)
- Suitable as part of a listed assembly per NEC® 348.20(A)(2)(b)
- Equipment ground in accordance with NEC® 250.118(5)
- Other Spaces Used for Environmental Air (Plenums) per NEC® 300.22(C)
- Cable Trays per NEC® 392.10(A) and Table 392.10(A)
- Raceway for Tap Conductors for Luminaires per NEC® 348.20(A)(2)(c) and 410.117(C)
- Connection to a motor terminal enclosure per NEC® 430.223
- Class I Division 2 per NEC® 501.10(B)(2)(2)
- Neon Secondary-Circuit Wiring 1000V or Less per NEC® 600.31(A)
- Neon Secondary-Circuit Wiring Over 1000V per NEC® 600.32(A)(1)
- Manufactured Wiring Systems per 604.100(A)(2)
- Elevators, Dumbwaiters, Escalators, Moving walks, Platform and Stairway Chairlifts per NEC® 620.21
- Under Raised Floors per NEC® 645.5(E)(1)(b)(10)
- Solar Photovoltaic (PV) Systems per NEC® 690.31(A)
- Fuel Cell Systems per NEC® 692.31
- Wind Electric Systems per NEC® 694.30(A)
- Critical Operations Power Systems (COPS) where flexibility is required per NEC® 708.10(C)(1)(3)(b)
- Optical Fiber Cables for installation within buildings per NEC® 770.110(A)(1)
- Communications Circuit Wires and Cables for installation within buildings per NEC® 800.110(A)(1)
- Community Antenna Television and Radio Coaxial Cables for installation within buildings per NEC® 820.110(A)(1)
- Low and Medium Power Network-Powered Broadband Cables for installation within buildings per NEC® 830.110(A)(1)

References & Ratings

- NFPA 70:
National Electric Code (NEC®) Articles 348, 250, 300, 392, 410, 423, 430, 501, 600, 604, 620, 645, 690, 692, 694, 708, 770, 800, 820 and 830
- UL 1
Standard for Flexible Metal Conduit
UL File Number E11831
Federal Specification WW-C-566C superseded by UL 1
- UL 1479
Fire Tests of Through-Penetration Firestops
UL Classified Through-Penetrating Product for Use in Through-Penetration Firestop Systems
- NEMA RV 3
Application and Installation Guidelines for Flexible and Liquidtight Flexible Metal Conduits
- C22.2 No. 56
CSA Standard for Flexible Metal Conduit and Liquid-Tight Flexible Metal Conduit
The ¾ Trade Size is the only Type RW FMC that is CSA Certified

UL Reduced Wall Steel Type RW FSC 5500 Series



Ordering Information						Product Dimensions / Bend Radius		
Product Code	Trade Size		Coil Length (ft)	Reel Length (ft)	Approx. Weight per 100 ft (lbs)	Internal Diameter (min / max) (in)	External Diameter (min / max) (in)	Bend Radius (in)
	in	mm						
5501-22-00*	3/8	12	25	-	17	0.375 / 0.393	0.560 / 0.610	2
5501-24-00*	3/8	12	50	-	17	0.375 / 0.393	0.560 / 0.610	2
5501-30-00*	3/8	12	100	-	17	0.375 / 0.393	0.560 / 0.610	2
5501-42-00*	3/8	12	250	-	17	0.375 / 0.393	0.560 / 0.610	2
5501-45-00*	3/8	12	-	500	17	0.375 / 0.393	0.560 / 0.610	2
5501-60-00*	3/8	12	-	1000	17	0.375 / 0.393	0.560 / 0.610	2
5502-22-00	1/2	16	25	-	27	0.625 / 0.645	0.860 / 0.920	3
5502-24-00	1/2	16	50	-	27	0.625 / 0.645	0.860 / 0.920	3
5502-30-00	1/2	16	100	-	27	0.625 / 0.645	0.860 / 0.920	3
5502-45-00	1/2	16	-	500	27	0.625 / 0.645	0.860 / 0.920	3
5502-60-00	1/2	16	-	1000	27	0.625 / 0.645	0.860 / 0.920	3
5503-22-00	3/4	21	25	-	35	0.812 / 0.835	1.045 / 1.105	4
5503-24-00	3/4	21	50	-	35	0.812 / 0.835	1.045 / 1.105	4
5503-30-00	3/4	21	100	-	35	0.812 / 0.835	1.045 / 1.105	4
5503-45-00	3/4	21	-	500	35	0.812 / 0.835	1.045 / 1.105	4
5503-60-00	3/4	21	-	1000	35	0.812 / 0.835	1.045 / 1.105	4
5504-24-00	1	27	50	-	51	1.000 / 1.040	1.300 / 1.380	5
5504-80-00	1	27	-	300	51	1.000 / 1.040	1.300 / 1.380	5
5505-24-00	1 1/4	35	50	-	63	1.250 / 1.300	1.550 / 1.630	6.25
5505-40-00	1 1/4	35	-	200	63	1.250 / 1.300	1.550 / 1.630	6.25
5506-22-00	1 1/2	41	25	-	76	1.500 / 1.575	1.850 / 1.950	7.50
5506-35-00	1 1/2	41	-	150	76	1.500 / 1.575	1.850 / 1.950	7.50
5506-80-00	1 1/2	41	-	300	76	1.500 / 1.575	1.850 / 1.950	7.50
5507-22-00	2	53	25	-	100	2.000 / 2.080	2.350 / 2.450	10
5507-35-00	2	53	-	150	100	2.000 / 2.080	2.350 / 2.450	10
5508-22-00	2 1/2	63	25	-	165	2.500 / -	2.860 / 3.060	12.5
5508-35-00	2 1/2	63	-	150	165	2.500 / -	2.860 / 3.060	12.5
5509-22-00	3	78	25	-	197	3.000 / -	3.360 / 3.560	15
5509-30-00	3	78	-	100	197	3.000 / -	3.360 / 3.560	15
5510-22-00	3 1/2	91	25	-	230	3.500 / -	3.860 / 4.060	17.5
5510-30-00	3 1/2	91	-	100	230	3.500 / -	3.860 / 4.060	17.5
5511-22-00	4	103	25	-	263	4.000 / -	4.360 / 4.560	20
5511-30-00	4	103	-	100	263	4.000 / -	4.360 / 4.560	20

NOTE: All dimensions and weights are subject to normal manufacturing tolerances. *CSA certified. Review NEC® 348.60 and 250.118(5) for grounding requirements. Continuous length reels with no solder joints or connectors are available on sizes. Review NEC® 348.60 and 250.118(5) for grounding requirements.