

TECHNICAL DATA SHEET - INTERACTIVE PDF

Duct Spacer, Snap-Loc® base and intermediate spacers

For use with non-metallic ducts

Carlon®



01



02

01 Base spacer
02 Intermediate spacer

Features:

- Side dovetail rail and groove design allows for side-by-side interchangeability of conduit spacer sizes while maintaining horizontal stability.
- Locking keyways incorporated into intermediate spacers eliminate the need for costly top spacers in each size. The locking keyways provide for the use of a beaded strap that helps secure the top section of conduit.
- 1" and 2" Snap-Loc® Reducers allow fixturing of 1" or 2" conduit inside larger spacers.
- The Snap-Loc® Rebar Holder helps provide stabilization on large banks of spacers.

Snap-Loc® duct spacers help provide stability, consistent separation and relieve direct stress for duct materials encased in concrete and direct bury applications.

3-Part Specification:
Tools and Calculators

Applications:

- Concrete-Encased
 - Direct-Burial
- Note: Purchaser is responsible for installation design and determination of the appropriateness of the product for any specific application.

Material:

- High Impact Polystyrene

Table data:

- [Base spacer](#)
- [Intermediate spacer](#)

TECHNICAL DATA SHEET - INTERACTIVE PDF

Duct Spacer, Snap-Loc® base and intermediate spacers

For use with non-metallic ducts

Carlon®



01



02

01 Base spacer
02 Intermediate spacer

Features:

- Side dovetail rail and groove design allows for side-by-side interchangeability of conduit spacer sizes while maintaining horizontal stability.
- Locking keyways incorporated into intermediate spacers eliminate the need for costly top spacers in each size. The locking keyways provide for the use of a beaded strap that helps secure the top section of conduit.
- 1" and 2" Snap-Loc® Reducers allow fixturing of 1" or 2" conduit inside larger spacers.
- The Snap-Loc® Rebar Holder helps provide stabilization on large banks of spacers.

Snap-Loc® duct spacers help provide stability, consistent separation and relieve direct stress for duct materials encased in concrete and direct bury applications.

3-Part Specification:
Tools and Calculators

Applications:

- Concrete-Encased
 - Direct-Burial
- Note: Purchaser is responsible for installation design and determination of the appropriateness of the product for any specific application.

Material:

- High Impact Polystyrene

Table data:

- [Base spacer](#)
- [Intermediate spacer](#)

Duct Spacer, Snap-Loc® base spacer

For use with nonmetallic ducts

Product selection and dimensions (inches)				
Part no.	Description	A	B	C
S288JHN	2 x 1½	4.000	1.250	4.25
S288JJN	2 x 2	4.500	1.250	4.25
S288JLN	2 x 3	5.500	1.250	4.25
S288LHN	3 x 1½	5.125	1.812	4.81
S288LJN	3 x 2	5.625	1.812	4.81
S288LLN	3 x 3	6.625	1.812	4.81
S288NFN	4 x 1	5.609	2.312	4.50
S288NHN	4 x 1½	6.125	2.312	4.50
S288NJN	4 x 2	6.625	2.312	4.50
S288NLN	4 x 3	7.625	2.312	4.50
S288PHN	5 x 1½	7.190	2.845	5.84
S288PJN	5 x 2	7.690	2.845	5.84
S288PLN	5 x 3	8.690	2.845	5.84
S288RHN	6 x 1½	8.250	3.375	6.38
S288RJN	6 x 2	8.750	3.375	6.38
S288RLN	6 x 3	9.750	3.375	6.38
S288SHN	8 x 1½	10.255	4.378	7.38
S288SJN	8 x 2	10.755	4.378	7.38
S288SLN	8 x 3	11.755	4.378	7.38

Note: Product must be installed in accordance with applicable national and local electrical codes.

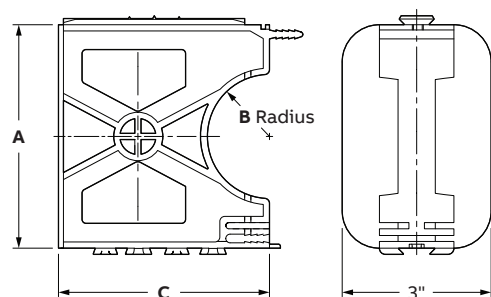

Duct Spacer, Snap-Loc® intermediate spacer

For use with nonmetallic ducts

Product selection and dimensions (inches)				
Part no.	Description	A	B	C
S289JHN	2 x 1½	4.000	1.250	3.88
S289JJN	2 x 2	4.500	1.250	4.38
S289JLN	2 x 3	5.500	1.250	5.38
S289LHN	3 x 1½	5.125	1.812	5.01
S289LJN	3 x 2	5.625	1.812	5.51
S289LLN	3 x 3	6.625	1.812	6.51
S289NFN	4 x 1	5.609	2.312	5.73
S289NHN	4 x 1½	6.125	2.312	6.01
S289NJN	4 x 2	6.625	2.312	6.51
S289NLN	4 x 3	7.625	2.312	7.51
S289PHN	5 x 1½	7.190	2.845	7.07
S289PJN	5 x 2	7.690	2.845	7.57
S289PLN	5 x 3	8.690	2.845	8.57
S289RHN	6 x 1½	8.250	3.375	8.14
S289RJN	6 x 2	8.750	3.375	8.64
S289RLN	6 x 3	9.750	3.375	9.64
S289SHN	8 x 1½	10.255	4.378	10.14
S289SJN	8 x 2	10.755	4.378	10.64
S289SLN	8 x 3	11.755	4.378	11.64

Note: Product must be installed in accordance with applicable national and local electrical codes.

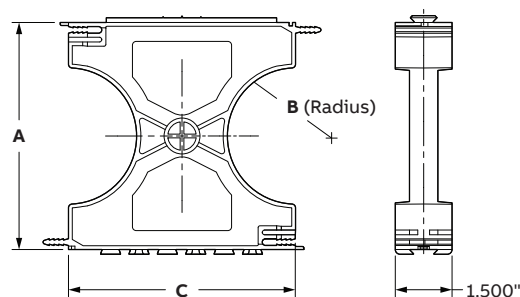

Part number key:

