

NEW!
more on
reverse

Non-metallic FR Series Device & Fixture Boxes

Forms Protective Barrier Against Water, Air Intrusion • Adjustable Depth

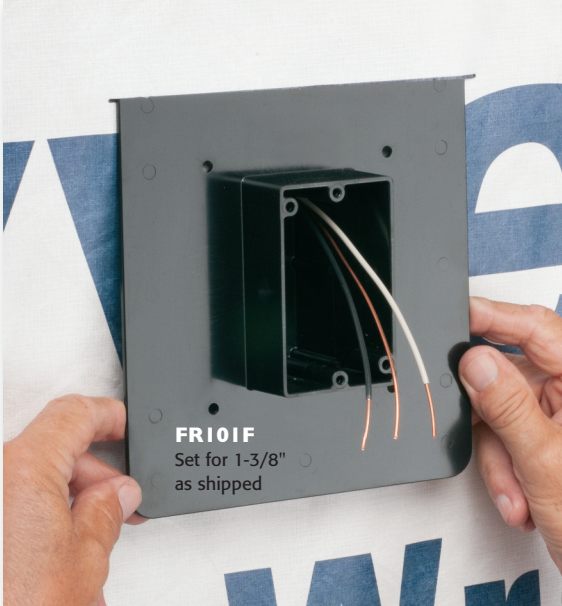

**Extra-wide flanges
prevent water and
air intrusion...**

**No need for
gaskets or caulking!**

Fast, easy installation

For New Construction

NEW!



Designed for new construction, Arlington's non-metallic FR series device and fixture boxes mount directly to a flat surface. They have interchangeable backs and extension rings that allow *ONE* box to work with almost any exterior wall finish thickness or cladding system, including engineered foam/stucco systems, without buying extra separate pieces.

All ship pre-assembled; ready for installations with 1-3/8" finish thicknesses.

Altering the FR101F or FR420F boxes for 5/8" or 7/8" finish thicknesses is easy! Remove the *back* and re-install it on the *opposite* side of the box for the 5/8" depth. Add the extension ring for 7/8".

For fixtures, change the finish thickness dimension on our pan boxes by adding or removing the desired extension ring(s) *without removing the back*.

- Extra-wide flanges help meet the International Energy Conservation Code by creating a protective barrier against air (and water) infiltration – No gaskets or caulking required
- Non-corrosive, non-conductive... Compatible with most building material surfaces
- UL Listed



FR Series Boxes ship pre-assembled; ready for 1-3/8" wall finish thickness



FR101F
for Devices



FR420F
for Fixtures



FR405F
Pan Box
for Fixtures

**Converts FAST
for use
on any
cladding
system
up to 1-7/8"**



Patent pending



Arlington®

1 Stauffer Industrial Park
Scranton, PA 18517
800/233.4717
Fax 570/562.0646
www.aifittings.com

Non-corrosive, Non-conductive FR Series Boxes



Wide Flanges prevent Air and Water Intrusion

FOR INSTALLATION FR101F Device Box (or FR420F Fixture Box)

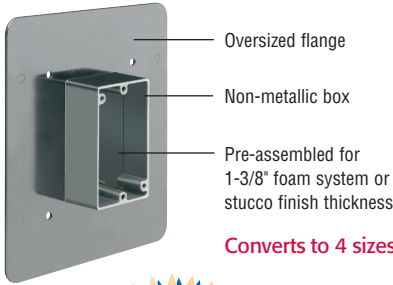

Converts to 4 sizes!



Pre-assembled FR405F Pan Box 1-3/8"

* Stationary back (no removal)



Remove 3/4" extension ring for 5/8" finish thickness

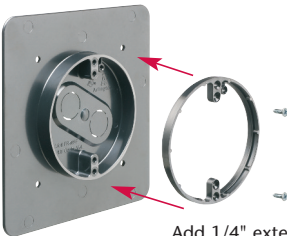

Add 1/4" extension ring for 7/8" finish thickness

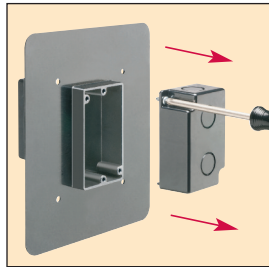

1 For 5/8" wall finish thickness loosen two screws, remove back.

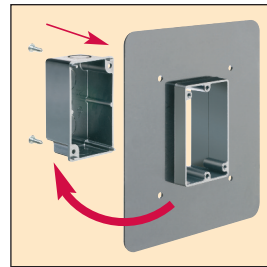

2 Re-install the back on the OPPOSITE side of the box.



3 Assembled for 5/8" finish thickness.

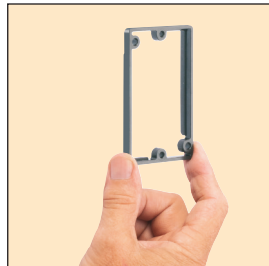

5 For 7/8" wall finish thickness, install the 1/4" extension ring...

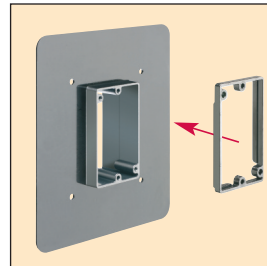

...to the front of the box.



FR420F for Fixtures

FR420F installs the same way

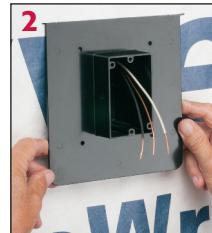
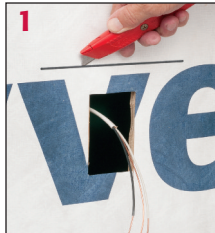

For New Construction

Install FR series box BEFORE (above)...

or AFTER weather barrier house wrap (right)

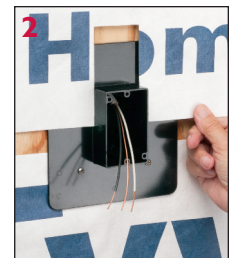
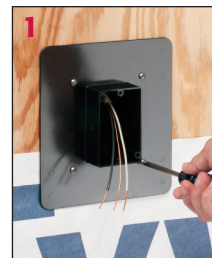

1 Stauffer Industrial Park
Scranton, PA 18517
800/233.4717
Fax 570/562.0646
www.aifittings.com

CATALOG NUMBER	UPC/DCI/NAED MFG #01 8997	APPLICATION	AS SHIPPED (1-3/8" finish)	PLUS 1/4" (1-5/8" finish)	UNIT/STD PKG
FR101F	12680	Device Box	21.8 cu. in.	23.8 cu. in.	10
FR420F	09615	Fixture box	19.5 cu. in.	22.0 cu. in.	10
			(for 1-3/8" finish)	(for 7/8" finish)	(for 5/8" finish)
FR405F	12681	Pan Box	12.8 cu. in.	7.3 cu. in.	4.8 cu. in.

FR101F and FR420F include: Flanged box for device or fixture, back panel, 1/4" extension ring, (4) #8 x 1/2" sheet metal screws, one each: NM94 connector and NM900 plug.

FR405F includes: Flanged pan box for fixture, one each: 1/4" and 3/4" extension rings, (2) #8 x 1/2" screws, (2) #8 x 1-1/4" screws, one each: NM94 connector and NM900 plug.

Patents pending
FR Boxes REV0713/25M

Distributed by

NEW!
more on
reverse

Non-metallic FR Series Device & Fixture Boxes

Forms Protective Barrier Against Water, Air Intrusion • Adjustable Depth

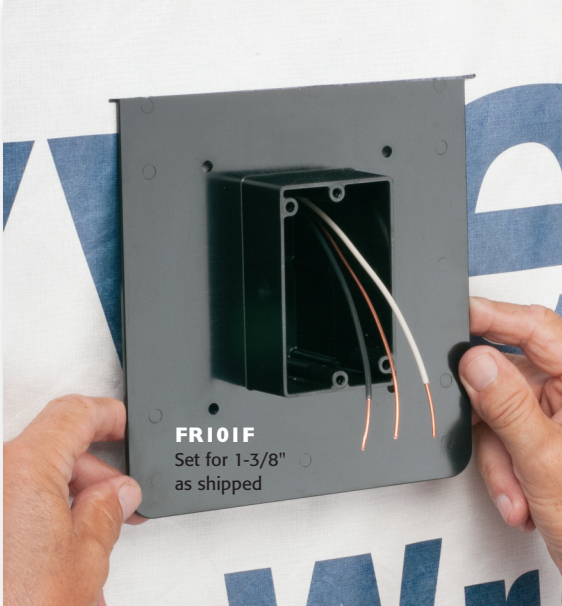

**Extra-wide flanges prevent water and air intrusion...
No need for gaskets or caulking!
Fast, easy installation**

For New Construction



Designed for new construction, Arlington's non-metallic FR series device and fixture boxes mount directly to a flat surface. They have interchangeable backs and extension rings that allow *ONE* box to work with almost any exterior wall finish thickness or cladding system, including engineered foam/stucco systems, without buying extra separate pieces.

All ship pre-assembled; ready for installations with 1-3/8" finish thicknesses.

Altering the FR101F or FR420F boxes for 5/8" or 7/8" finish thicknesses is easy! Remove the *back* and re-install it on the *opposite* side of the box for the 5/8" depth. Add the extension ring for 7/8".

For fixtures, change the finish thickness dimension on our pan boxes by adding or removing the desired extension ring(s) *without removing the back*.

- Extra-wide flanges help meet the International Energy Conservation Code by creating a protective barrier against air (and water) infiltration – No gaskets or caulking required
- Non-corrosive, non-conductive... Compatible with most building material surfaces
- UL Listed



FR Series Boxes ship pre-assembled; ready for 1-3/8" wall finish thickness



FR101F
for Devices



FR420F
for Fixtures



FR405F
Pan Box
for Fixtures

Converts FAST for use on any cladding system up to 1-7/8"



Patent pending



Arlington®

1 Stauffer Industrial Park
Scranton, PA 18517
800/233.4717
Fax 570/562.0646
www.aifittings.com

Non-corrosive, Non-conductive FR Series Boxes



Wide Flanges prevent Air and Water Intrusion

FOR INSTALLATION FR101F Device Box (or FR420F Fixture Box)

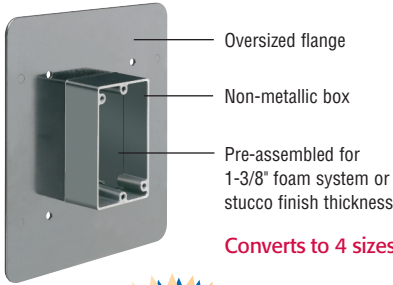

Converts to 4 sizes!



Pre-assembled FR405F Pan Box 1-3/8"

* Stationary back (no removal)



Remove 3/4" extension ring for 5/8" finish thickness

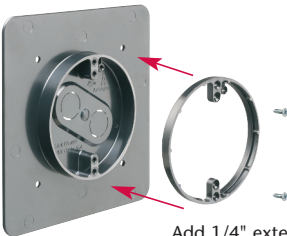

Add 1/4" extension ring for 7/8" finish thickness

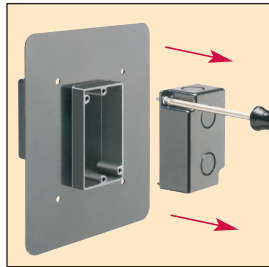

1 For 5/8" wall finish thickness loosen two screws, remove back.

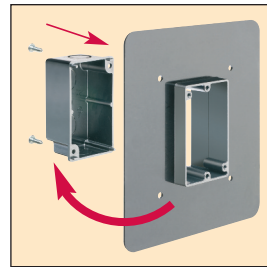

2 Re-install the back on the OPPOSITE side of the box.



3 Assembled for 5/8" finish thickness.



5 For 7/8" wall finish thickness, install the 1/4" extension ring...

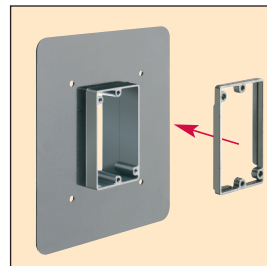

...to the front of the box.



FR420F for Fixtures

FR420F installs the same way

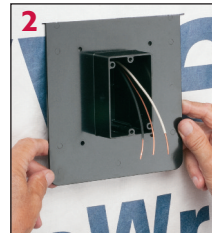
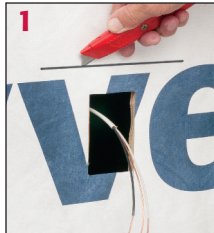

For New Construction

Install FR series box BEFORE (above)...

or AFTER weather barrier house wrap (right)

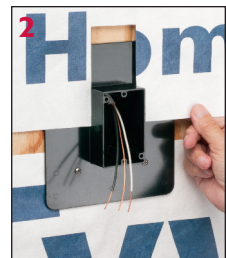

1 Stauffer Industrial Park
Scranton, PA 18517
800/233.4717
Fax 570/562.0646
www.aifittings.com

CATALOG NUMBER	UPC/DCI/NAED MFG #01 8997	APPLICATION	AS SHIPPED (1-3/8" finish)	PLUS 1/4" (1-5/8" finish)	UNIT/STD PKG
FR101F	12680	Device Box	21.8 cu. in.	23.8 cu. in.	10
FR420F	09615	Fixture box	19.5 cu. in.	22.0 cu. in.	10
			(for 1-3/8" finish)	(for 7/8" finish)	(for 5/8" finish)
FR405F	12681	Pan Box	12.8 cu. in.	7.3 cu. in.	4.8 cu. in.

FR101F and FR420F include: Flanged box for device or fixture, back panel, 1/4" extension ring, (4) #8 x 1/2" sheet metal screws, one each: NM94 connector and NM900 plug.

FR405F includes: Flanged pan box for fixture, one each: 1/4" and 3/4" extension rings, (2) #8 x 1/2" screws, (2) #8 x 1-1/4" screws, one each: NM94 connector and NM900 plug.

Patents pending
FR Boxes REV0713/25M

Distributed by