

# BC Beam Clamp – BC

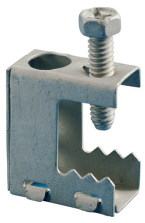

- Easy installation to beam flanges

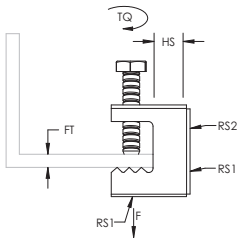

Part Number	BC
Material	Spring Steel
Finish	nVent CADDY Armour
Rod Size 1 (RS1)	1/4"
Rod Size 2 (RS2)	#10
Hole Size (HS)	7/16"
Flange Thickness (FT)	1/2" Max
Torque (TQ)	20 in lb
Static Load (F)	100 lb
Certifications	cULus
Standard Packaging Quantity	100 pc
UPC	78285619100

Setscrew must be tightened and torqued onto the sloped side of the I-beam.

UL, UR, cUL, cUR, cULus and cURus are registered certification marks of UL LLC.

#### WARNING

nVent products shall be installed and used only as indicated in nVent's product instruction sheets and training materials. Instruction sheets are available at [www.ericco.com](http://www.ericco.com) and from your nVent customer service representative. Improper installation, misuse, misapplication or other failure to completely follow nVent's instructions and warnings may cause product malfunction, property damage, serious bodily injury and death and/or void your warranty.

© 2018 nVent All rights reserved

nVent, nVent CADDY, nVent ERICO, nVent ERIFLEX and nVent LENTON are owned by nVent or its global affiliates.

All other trademarks are the property of their respective owners. nVent reserves the right to change specifications without prior notice.



# BC Beam Clamp – BC

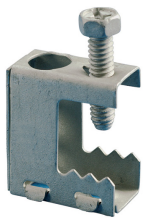

- Easy installation to beam flanges

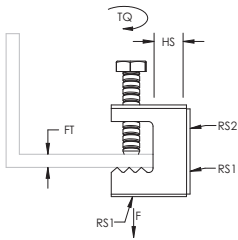

Part Number	BC
Material	Spring Steel
Finish	nVent CADDY Armour
Rod Size 1 (RS1)	1/4"
Rod Size 2 (RS2)	#10
Hole Size (HS)	7/16"
Flange Thickness (FT)	1/2" Max
Torque (TQ)	20 in lb
Static Load (F)	100 lb
Certifications	cULus
Standard Packaging Quantity	100 pc
UPC	78285619100

Setscrew must be tightened and torqued onto the sloped side of the I-beam.

UL, UR, cUL, cUR, cULus and cURus are registered certification marks of UL LLC.

#### WARNING

nVent products shall be installed and used only as indicated in nVent's product instruction sheets and training materials. Instruction sheets are available at [www.ericco.com](http://www.ericco.com) and from your nVent customer service representative. Improper installation, misuse, misapplication or other failure to completely follow nVent's instructions and warnings may cause product malfunction, property damage, serious bodily injury and death and/or void your warranty.

© 2018 nVent All rights reserved

nVent, nVent CADDY, nVent ERICO, nVent ERIFLEX and nVent LENTON are owned by nVent or its global affiliates.

All other trademarks are the property of their respective owners. nVent reserves the right to change specifications without prior notice.

