

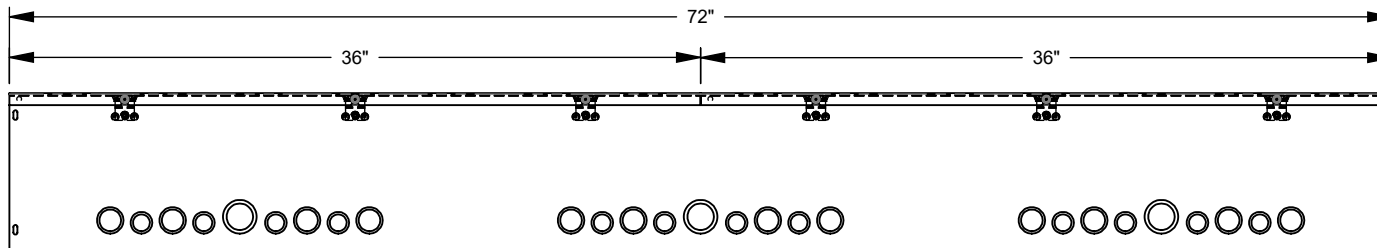

8872-GHC1-NK

| | |
|-------------------------------|---|
| Catalog Number | 8872-GHC1-NK |
| Marketing Product Description | 8x72x8 Hinge Cover Wireway Type 1 UL Listed Steel No Knockouts ANSI 61 Gray |
| UPC | 784572289475 |
| Length (IN) | 72 |
| Width (IN) | 8 |
| Height (IN) | 8 |
| Weight (LB) | 40 |
| Brand Name | Milbank |
| Type | Lay In Wireway |
| Application | Wireway |
| Standard | UL Listed |
| Cover Type | Hinge Cover |
| Enclosure | Indoor Enclosure |
| Nominal Cross Section | 8x8 |
| Straight Section Length | 72 |
| Material | Steel |
| Finish | ANSI 61 Gray Powder Coat Finish |
| Knockouts | False |
| NEMA Rating | Type 1 |

Please consult serving utility for their requirements prior to ordering or installing, as specifications and approvals vary by utility and may require local electrical inspector approval. All installations must be installed by a licensed electrician and must comply with all national and local codes, laws and regulations. Milbank reserves the right to make changes in specifications and features shown without notice or obligation.

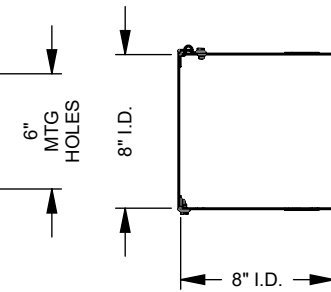
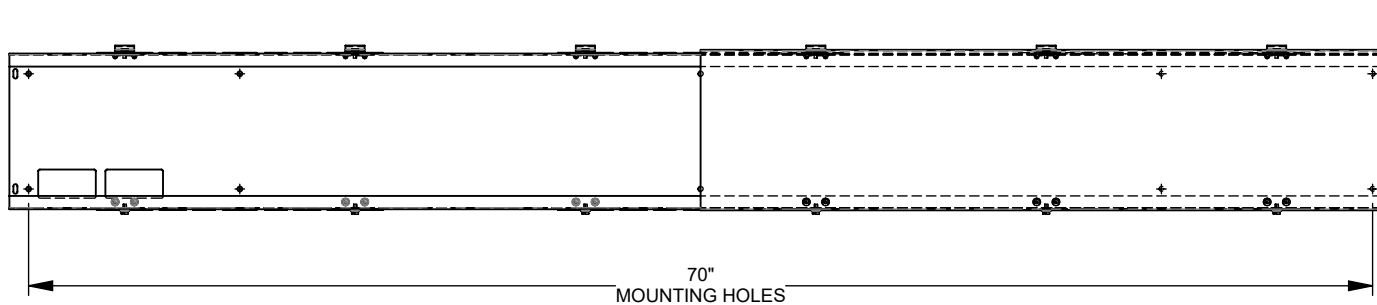
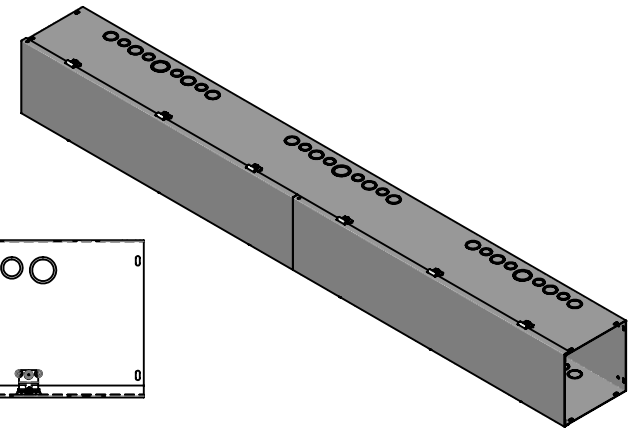
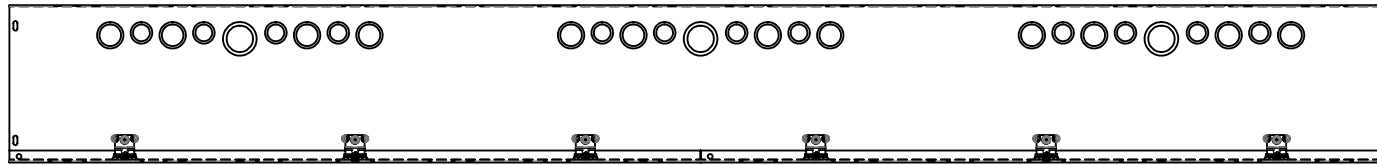

Version:

1

**All dimensions are +/- 1/16".
Drawing views are not to scale.**

Please consult serving utility for their requirements prior to ordering or installing, as specifications and approvals vary by utility, and may require local electrical inspector approval. All installations must be installed by a licensed electrician and must comply with all national and local codes, laws and regulations. Milbank reserves the right to make changes in specifications and features shown without notice or obligation.



8872-GHC1-NK

| | |
|-------------------------------|---|
| Catalog Number | 8872-GHC1-NK |
| Marketing Product Description | 8x72x8 Hinge Cover Wireway Type 1 UL Listed Steel No Knockouts ANSI 61 Gray |
| UPC | 784572289475 |
| Length (IN) | 72 |
| Width (IN) | 8 |
| Height (IN) | 8 |
| Weight (LB) | 40 |
| Brand Name | Milbank |
| Type | Lay In Wireway |
| Application | Wireway |
| Standard | UL Listed |
| Cover Type | Hinge Cover |
| Enclosure | Indoor Enclosure |
| Nominal Cross Section | 8x8 |
| Straight Section Length | 72 |
| Material | Steel |
| Finish | ANSI 61 Gray Powder Coat Finish |
| Knockouts | False |
| NEMA Rating | Type 1 |

Please consult serving utility for their requirements prior to ordering or installing, as specifications and approvals vary by utility and may require local electrical inspector approval. All installations must be installed by a licensed electrician and must comply with all national and local codes, laws and regulations. Milbank reserves the right to make changes in specifications and features shown without notice or obligation.

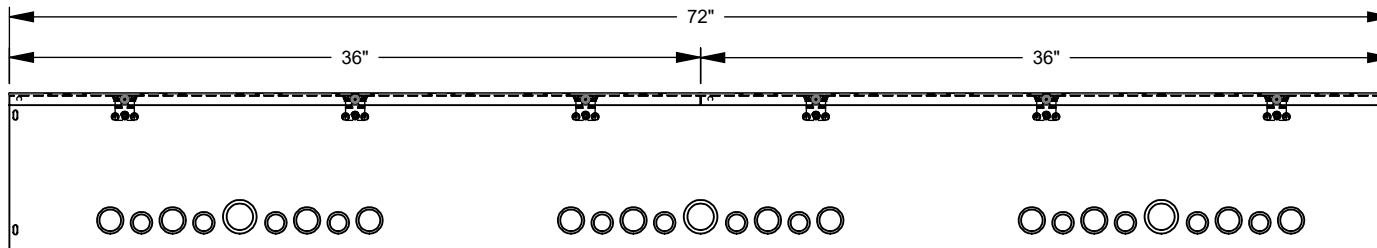
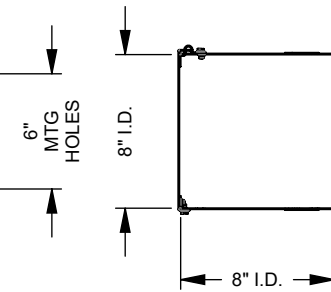
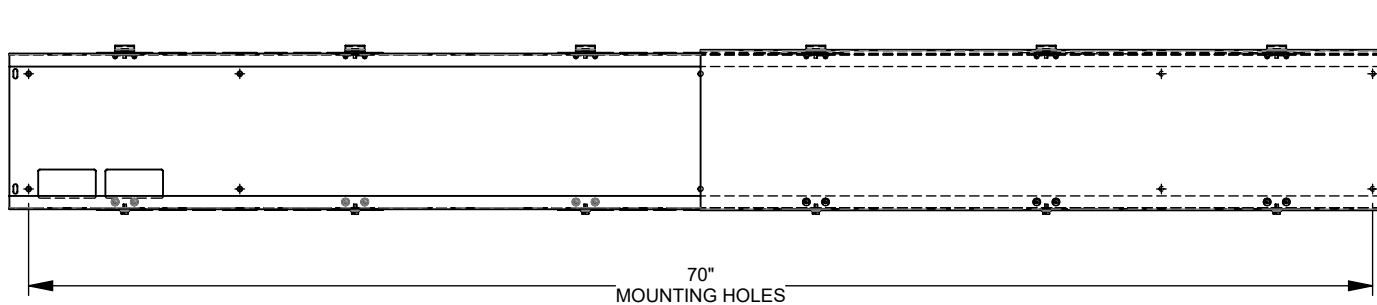
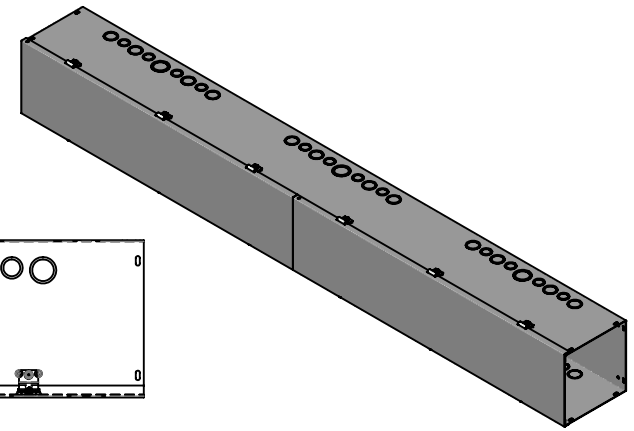
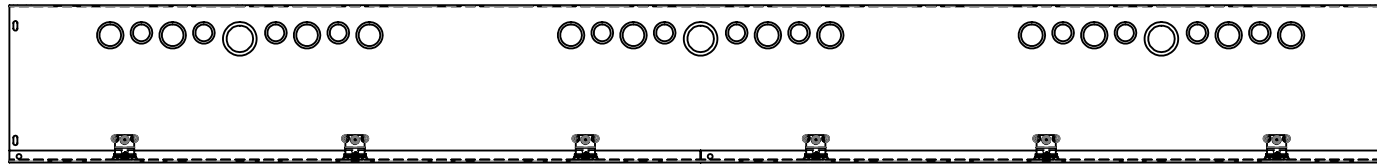

Version:

1

**All dimensions are +/- 1/16".
Drawing views are not to scale.**

Please consult serving utility for their requirements prior to ordering or installing, as specifications and approvals vary by utility, and may require local electrical inspector approval. All installations must be installed by a licensed electrician and must comply with all national and local codes, laws and regulations. Milbank reserves the right to make changes in specifications and features shown without notice or obligation.