

Fluorescent Lampholders

Slimline
660W, 600V/AC
660W, 1000V/AC

FEATURES

- For replacement use in fluorescent lighting fixtures.
- Plunger lampholders feature non-sticking, spring-loaded plunger to hold lamp securely.
- Captive pal nut for easy mounting.
- Push-in wire terminals feature release slots.
- Molded of durable white thermoset plastic.

Slimline Lampholders

660W 600V/AC

Description	Color	Catalog No.	
Stationary Type, Push Wire Cap, Slide-On Switch	White	□ 2506W	•
Stationary Type, Push Wire Cap, Screw Switch	White	□ 2503W	•

  Listed to UL1570; CSA certified



2506W

Slimline Lampholders

660W 1000V/AC

Description	Color	Catalog No.	
Stationary Type, Push Wire Cap, Slide-On Switch	White	□ 2507W	•
Stationary Type, Push Wire Cap, Screw Switch	White	□ 2504W	•

  Listed to UL1570; CSA certified



2504W

Fluorescent Lampholders

Medium Bi-Pin
660W, 600V/AC

FEATURES



- For replacement use in fluorescent lighting fixtures.
- Use for flush or surface mounting.
- Captive pal nut for easy mounting.
- Push-in wire terminals feature release slots.
- Molded of durable white thermoset plastic.

Slimline Lampholders

660W 600V/AC

Description	Color	Catalog No.	
Standard Type, Push Wire, Slide-On & Screw Switch	White	□ 2509W	•
Short Type, Push Wire, Slide-On & Screw Switch	White	□ 2510W	•
Standard Type, Screw Terminals, Screw Switch	White	□ 924W	•

  2509W & 2510W: Listed to UL1570; CSA certified

  924: cULus Listed to UL496, file no. E5833, certified to CSA C22.2, no. 43; NOM certified



2510W



924W

Dimensional Information: B-64

Fluorescent Lampholder Panel Cutout Information: See page F-20

Specification Information: Please visit www.cooperwiringdevices.com

 **NAFTA Compliant:** See page F-21

Metal Shell Lampholders

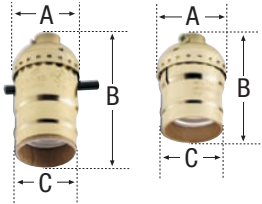

Family	A	B	C
Turn Knob, Pull Chain, Push Through	1.40" (35.6mm)	2.35" (59.7mm)	1.25" (31.8mm)
Keyless	1.40" (35.6mm)	2.00" (50.8mm)	1.25" (31.8mm)

Metal Shell Lampholder Interiors

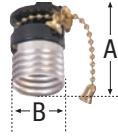

Cat. No.	A	B
962	1.87" (47.5mm)	1.09" (27.7mm)
3925	1.78" (45.2mm)	1.09" (27.7mm)
2982	1.71" (43.4mm)	1.09" (27.7mm)
942	1.74" (44.2mm)	1.09" (27.7mm)

Fixture Sockets

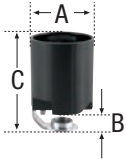

Cat. No.	A	B	C
968	1.35" (34.3mm)	0.40" (10.2mm)	1.85" (47.0mm)
969	1.38" (35.1mm)	0.44" (11.2mm)	1.90" (48.3mm)

Pigtail Lampholders



Cat. No.	A	B	C	D
722	1.60" (40.6mm)	-	1.47" (37.3mm)	1.32" (33.5mm)
124	1.63" (41.4mm)	1.36" (34.5mm)	1.75" (44.5mm)	1.50" (38.1mm)
145	1.63" (41.4mm)	1.36" (34.5mm)	1.75" (44.5mm)	1.50" (38.1mm)

Fluorescent Lampholders, Recessed Double Contact

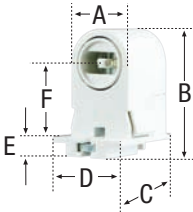

Cat. No.	A	B	C	D	E	F
2500W	1.12" (28.4mm)	2.31" (58.7mm)	1.81" (46.0mm)	1.44" (36.6mm)	0.59" (15.0mm)	1.17" (29.7mm)
2501W	1.12" (28.4mm)	2.31" (58.7mm)	1.81" (46.0mm)	1.44" (36.6mm)	0.59" (15.0mm)	1.17" (29.7mm)

Fluorescent Lampholders, Slimline

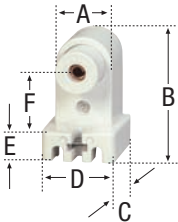

Cat. No.	A	B	C	D	E	F
2503W	1.12" (28.4mm)	2.33" (59.2mm)	1.66" (42.2mm)	1.45" (36.8mm)	0.59" (15.0mm)	1.17" (29.7mm)
2504W	1.12" (28.4mm)	2.33" (59.2mm)	1.66" (42.2mm)	1.45" (36.8mm)	0.59" (15.0mm)	1.17" (29.7mm)
2506W	1.13" (28.7mm)	1.73" (43.9mm)	1.48" (37.6mm)	1.31" (33.2mm)	0.32" (8.1mm)	1.30" (33.0mm)
2507W	1.13" (28.7mm)	1.73" (43.9mm)	1.50" (38.1mm)	1.31" (33.2mm)	0.32" (8.1mm)	1.30" (33.0mm)

Fluorescent Lampholders, Medium Bi-Pin

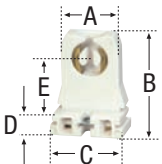

Cat. No.	A	B	C	D	E
924W	1.00" (25.4mm)	2.37" (60.2mm)	1.44" (36.6mm)	0.62" (15.7mm)	1.18" (30.0mm)
2509W	1.00" (25.4mm)	2.03" (51.6mm)	1.35" (34.3mm)	0.37" (9.4mm)	1.17" (29.7mm)
2510W	1.00" (25.4mm)	1.67" (42.2mm)	1.25" (31.8mm)	0.38" (9.7mm)	0.88" (22.4mm)